

Untergeschoss

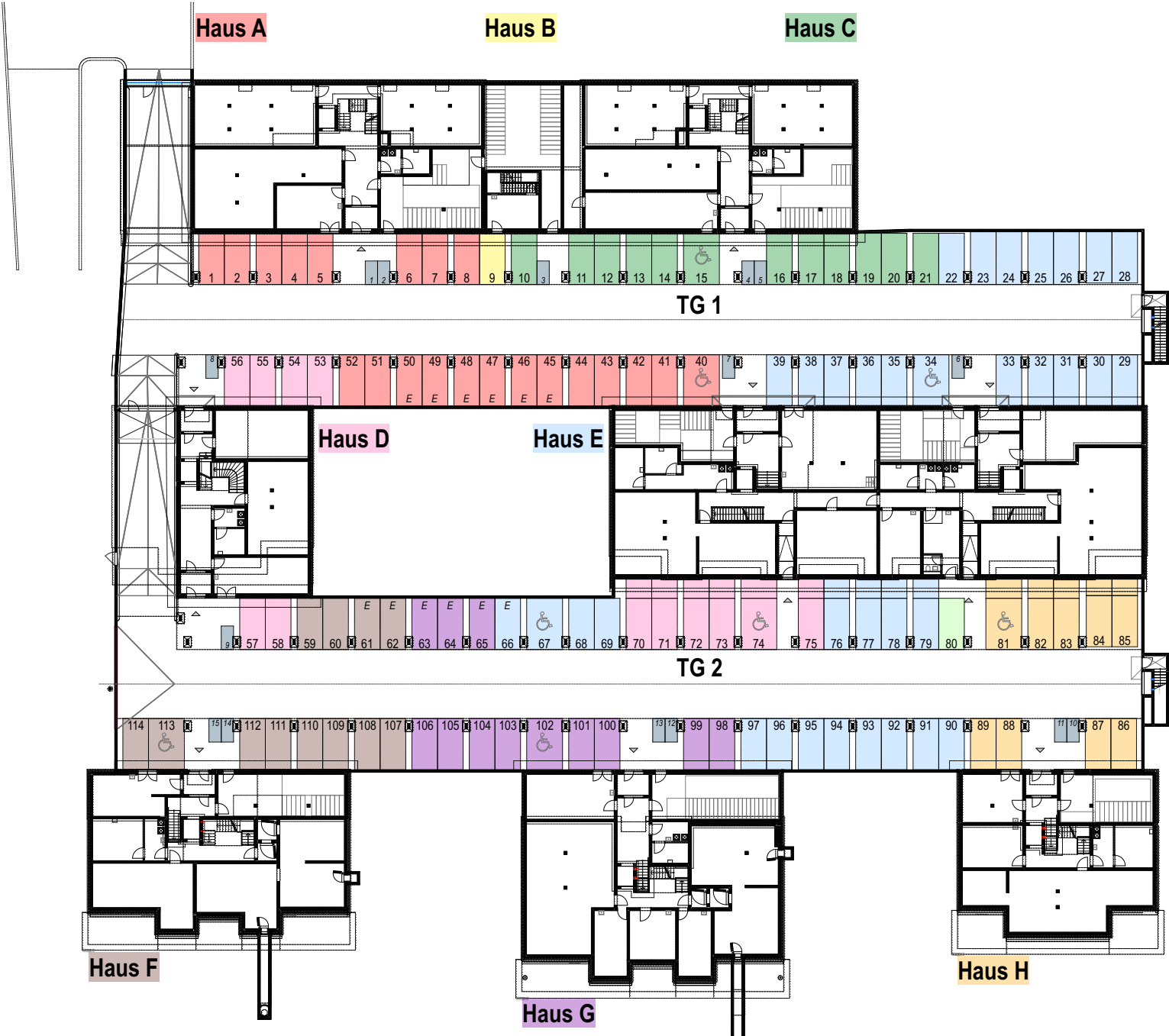

Zuteilung Parkplätze (PP)

- 21 PP Haus A
- 1 PP Haus B
- 12 PP Haus C
- 12 PP Haus D
- 34 PP Haus E
- 12 PP Haus F
- 12 PP Haus G
- 9 PP Haus H
- 1 PP Hausdienst

114 PP Total

- Motos-PP
- TG1 = 8 PP
- TG2 = 7 PP

